

X10 Midi Sounder Beacon

The X10 Midi sounder beacon is an industrial signaling alarm, available in 2 fade resistant body colours, 6 LED beacon colours, and low voltage variants. It is certified to IP66 and IP69, and verified to operate at extreme temperatures -40°C to 70°C, and is therefore suitable for use in harsh conditions where a robust industrial sounder beacon is required. The X10 Midi sounder beacon comes with an Eaton 10 year Extended Warranty and offers up to 110 dB(A) with 102 tones, and a versatile 4 stage alarm to allow you to retrofit to an existing installation.

Technical specifications

X10 Midi Sounder Beacon		
	Low voltage DC / AC product	
Rated voltage	10V - 60V DC	10V - 30V AC
Sounder only* (DIN Tone, High Vol)	35 - 100 mA	75 - 150 mA
AV* (DIN Tone, High Vol, 1Hz Flash)	45 - 200 mA	115 - 400 mA
Sound output	110dB	
Alarm tones	102	
Alarm stages	4	
Stage control options	+ve low voltage trigger -ve low voltage trigger +ve supply voltage trigger -ve supply voltage trigger Reverse polarity trigger	Dry /0 volt contact trigger
Flash rate	0.5Hz (30FPM) / 1Hz (60FPM) / Continuous / Off	
Operating temperature	-40°C to +70°C	
Ingress Protection (IP) rating	IP66 and IP69 (dust ingress/high pressure water jets)	
Warranty	10 years**	
Material	UV stabilised polycarbonate ASA	
Colour - housing	Red (RAL 3001) Dark grey (RAL7012)	
Colour - beacon	Red Magenta Amber Clear Blue Green	
Cable entry	Top: 2 x M20 threaded cable entries Bottom: 1 x M20 threaded cable entry	
Connecting terminals	up to 2.5mm ²	
Weight	0.800kg (Low voltage DC / AC)	

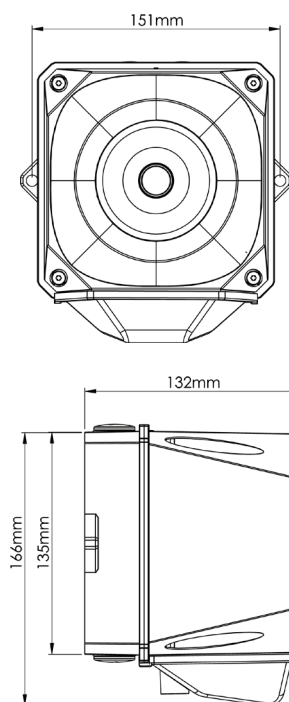

* Supply current range is based on variation of the supply voltage. A change in tone, volume or beacon settings will also impact the supply current.



** Terms and Conditions apply

Key features

- Up to 110dB(A) output
- IK08 Impact resist and Dual IP Rated to IP66 and IP69
- 10 year warranty**
- 102 tones facilitates install and retrofits accommodating a wide range of Industry requirements
- 6 lens colours available, secured by 1 single ¼ turn captive fastener
- 2 fade resistant housing colours available
- Up to 4 stage alarm, with multiple alert and control possibilities
- Modular LED beacon capable of multiple functionality on / off; 1/2Hz (30FPM) / 1Hz (60FPM)
- Temperature range -40°C to +70°C
- Captive salt water resistant stainless steel fasteners
- M20 pre drilled threaded cable entries fitted with IP69 blanking plugs as standard
- UV stabilised polycarbonate ASA
- Low Inrush current with a range of dB(A) outputs

X10 Housing colours

Housing colours

	R1 = Red (RAL3001)
	G1 = Dark grey (RAL7012)

X10 Modular lenses

Lens colours

	RL = Red lens
	AL = Amber lens
	BL = Blue lens
	GL = Green lens
	CL = Clear lens
	ML = Magenta lens

Catalogue numbers

Catalogue no.	Reference	Description
7092331FUL-0367	X10/CE/MDH/R1/10-60 VAC-DC	X10 midi, red housing, 10-60 VAC-DC
7092335FUL-0371	X10/CE/MDH/G1/10-60 VAC-DC	X10 midi, dark grey housing, 10-60 VAC-DC
7092382FUL-0590	X10/CE/MD/R1/RL/10-60 VAC-DC	X10 Midi sounder beacon, 10-60V AC-DC, Red housing, Red lens
7092383FUL-0591	X10/CE/MD/R1/AL/10-60 VAC-DC	X10 Midi sounder beacon, 10-60V AC-DC, Red housing, Amber lens
7092386FUL-0594	X10/CE/MD/G1/RL/10-60 VAC-DC	X10 Midi sounder beacon, 10-60V AC-DC, Dark grey housing, Red lens
7092387FUL-0595	X10/CE/MD/G1/AL/10-60 VAC-DC	X10 Midi sounder beacon, 10-60V AC-DC, Dark grey housing, Amber lens
7092339FUL-0375	X10/CE/M2B/RL	X10 midi beacon, red lens
7092340FUL-0376	X10/CE/M2B/AL	X10 midi beacon, amber lens
7092341FUL-0377	X10/CE/M2B/BL	X10 midi beacon, blue lens
7092342FUL-0378	X10/CE/M2B/GL	X10 midi beacon, green lens
7092343FUL-0379	X10/CE/M2B/CL	X10 midi beacon, clear lens
7092344FUL-0380	X10/CE/M2B/ML	X10 midi beacon, magenta lens